

REGELQUERSCHNITT M 1:100

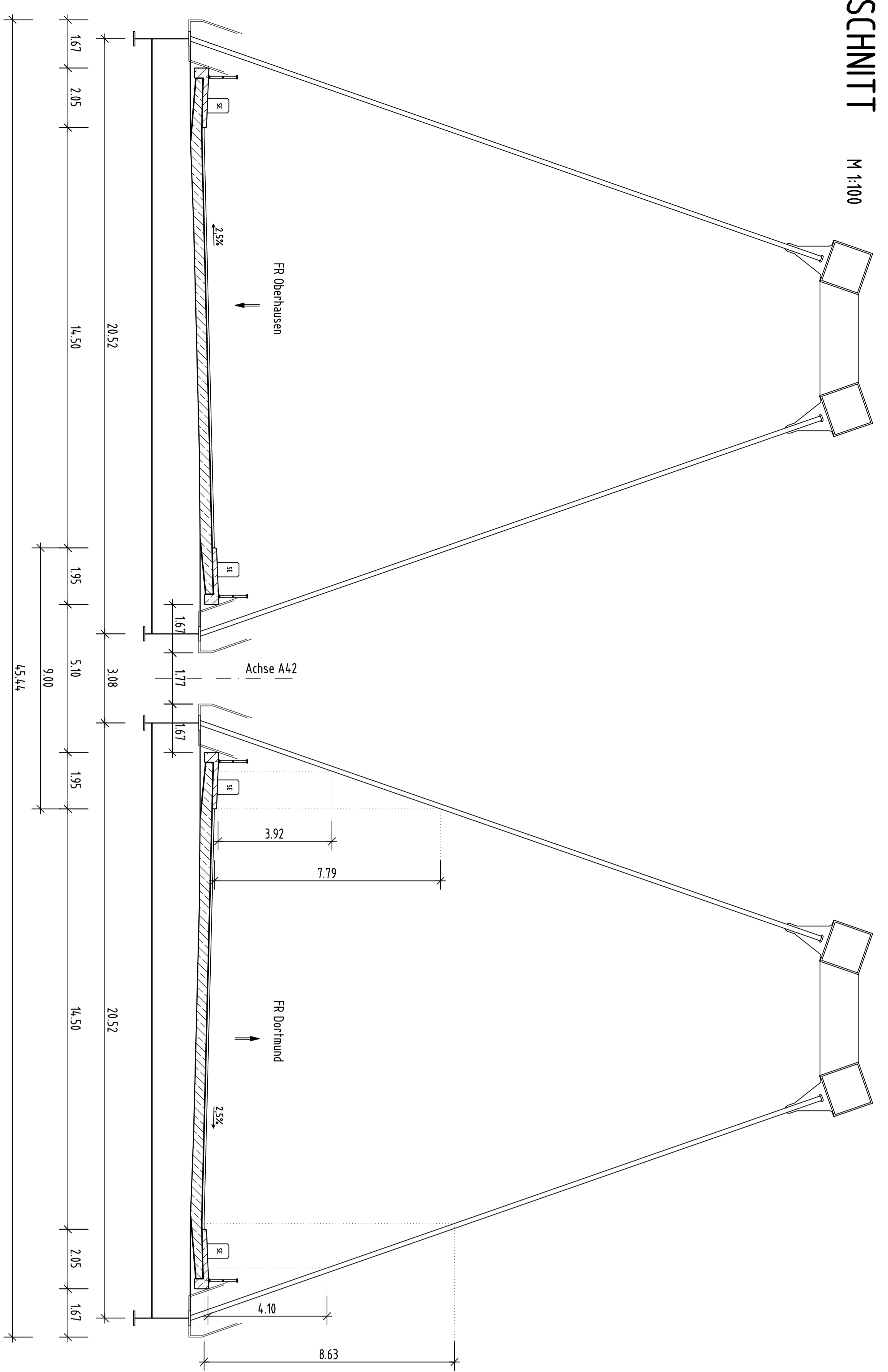

ANSICHT M 1:250

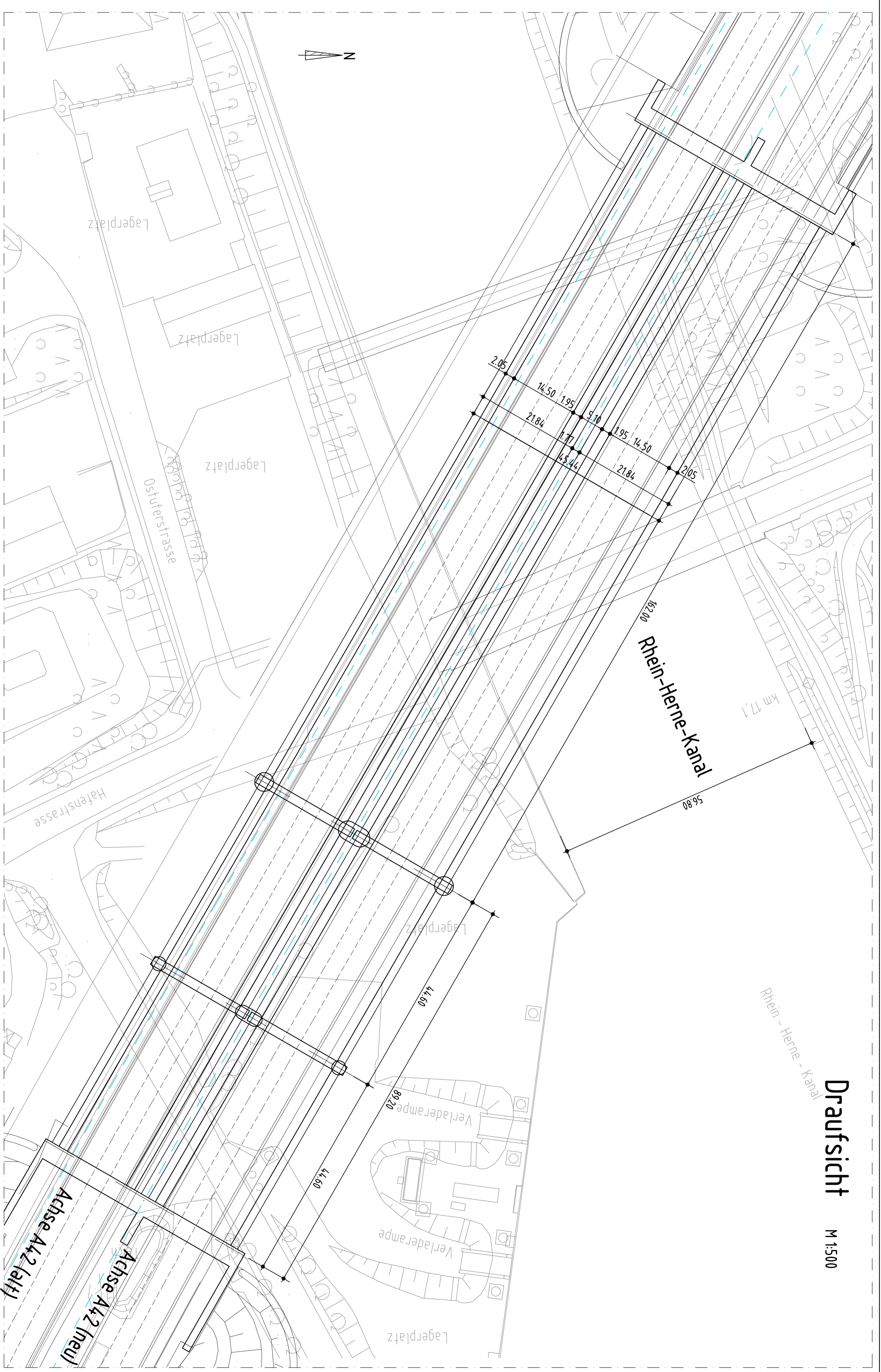
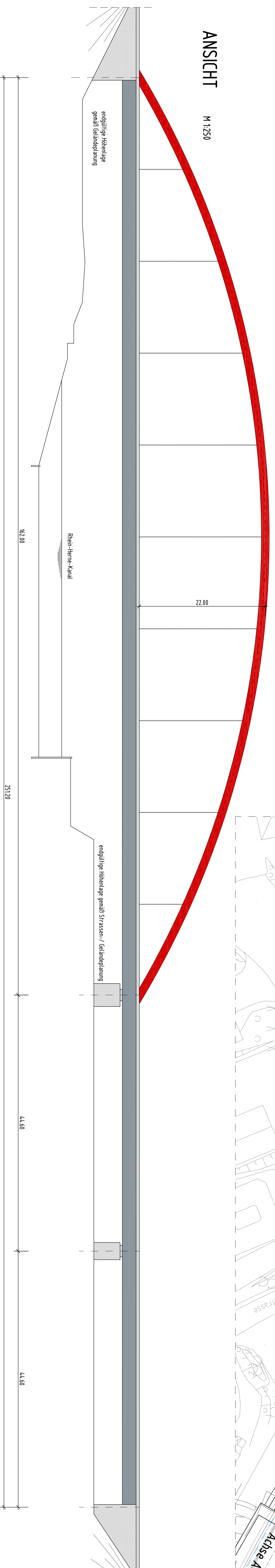

Draufsicht M 1:500

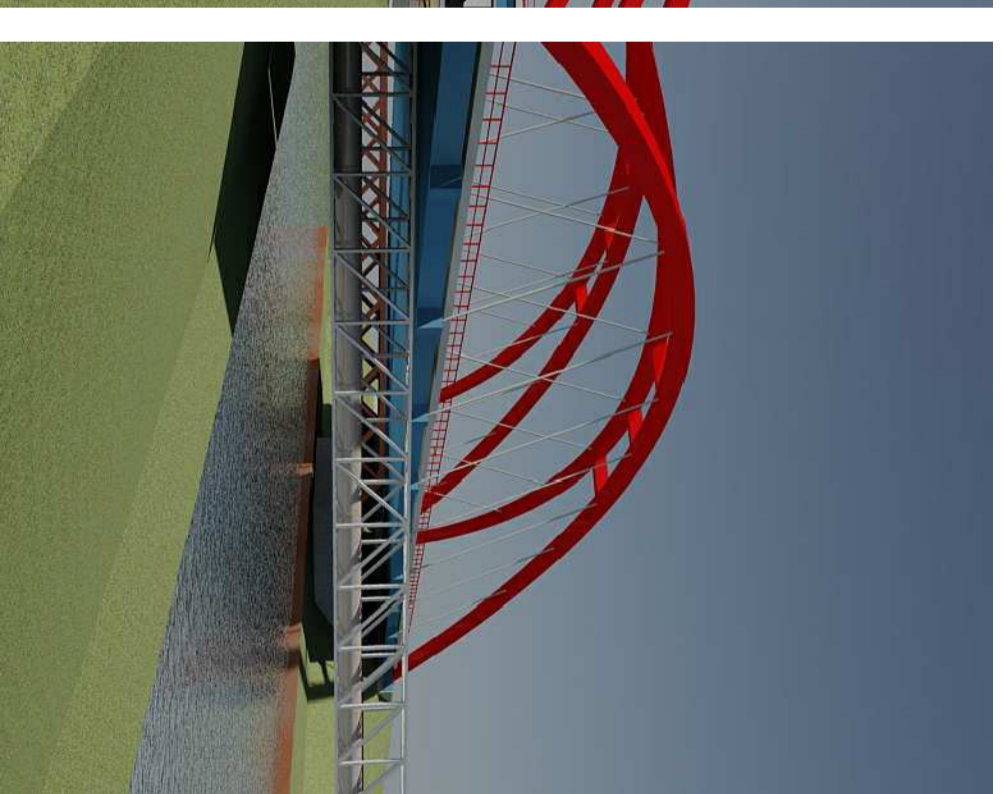
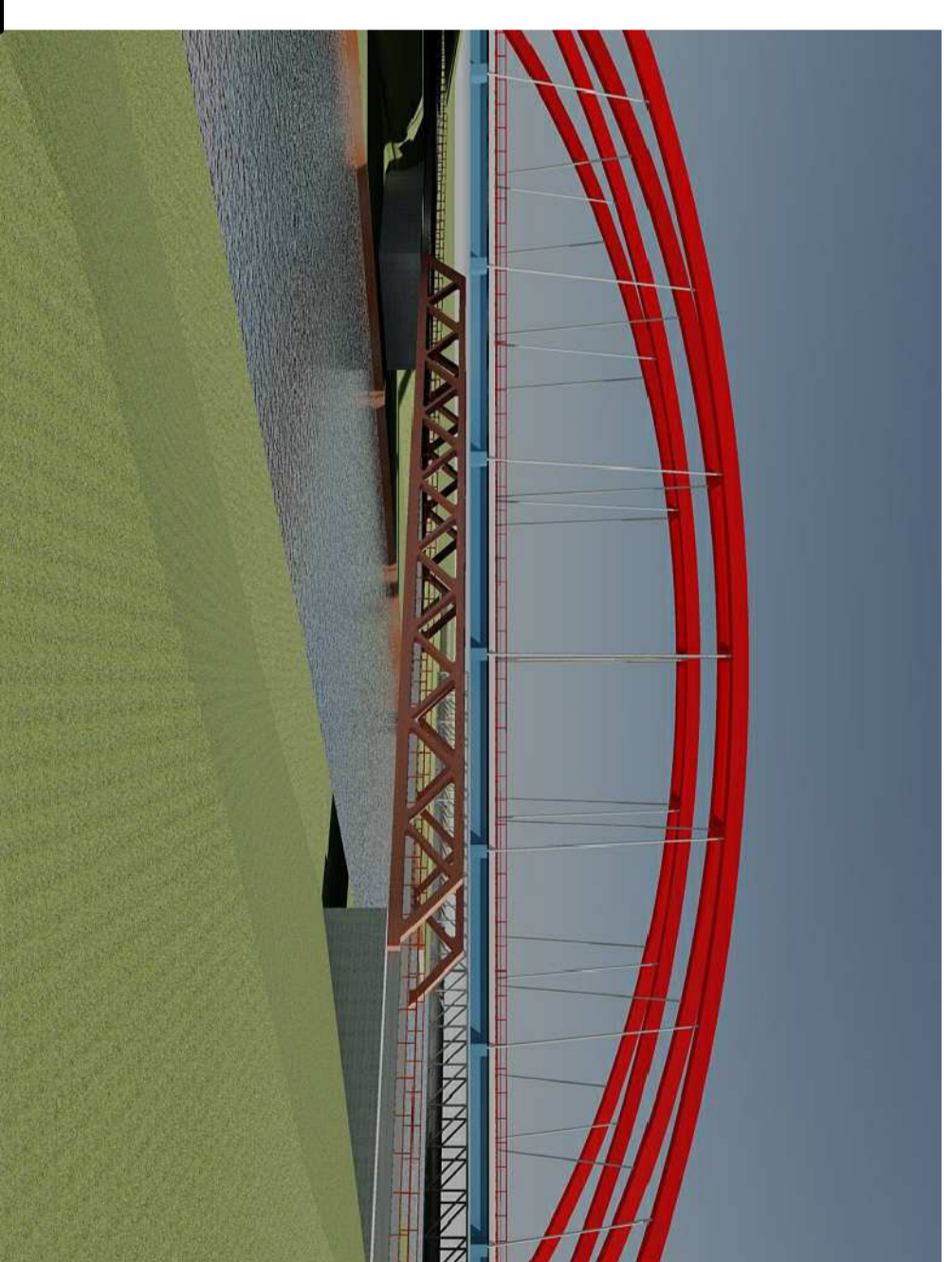
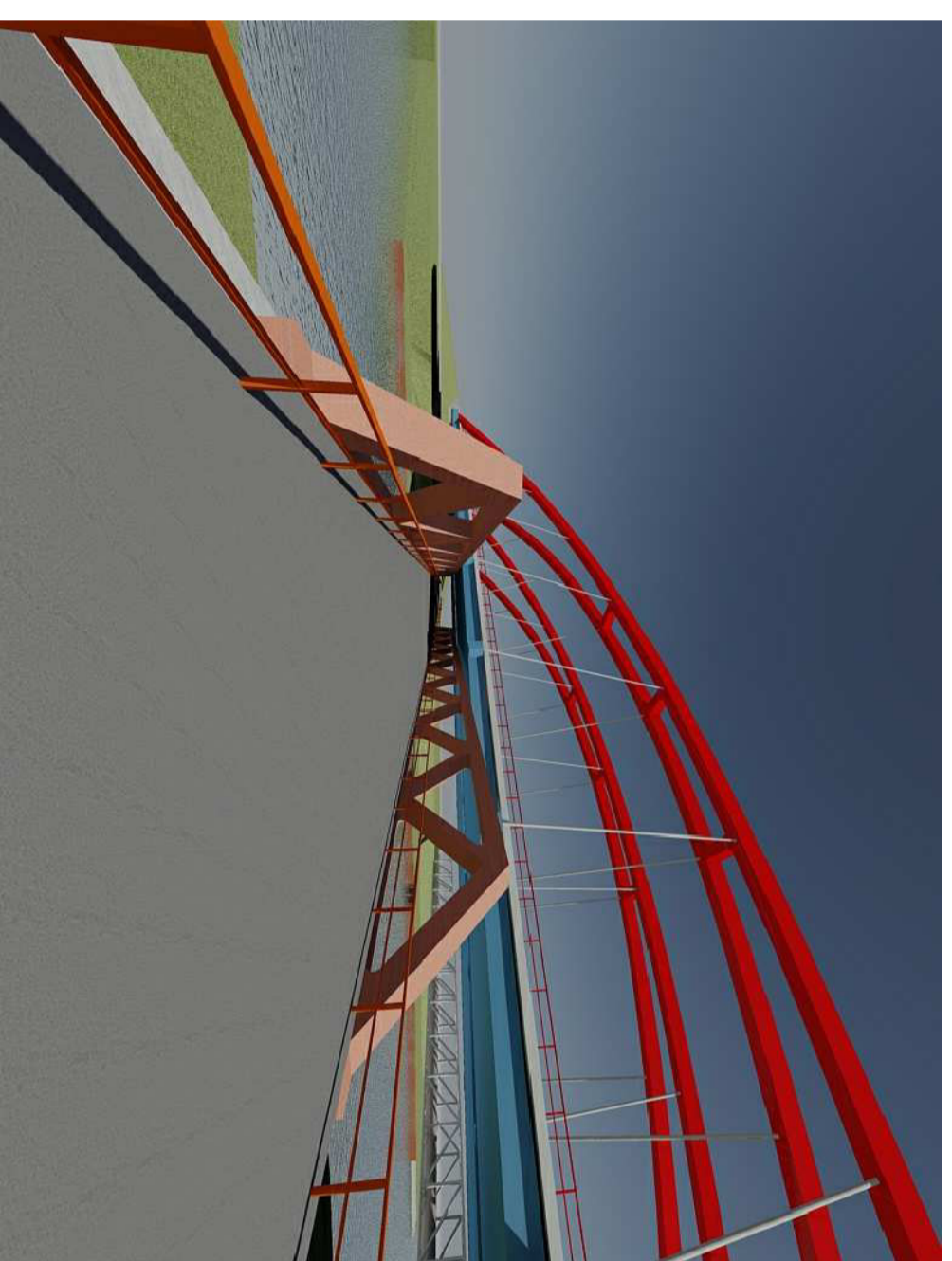
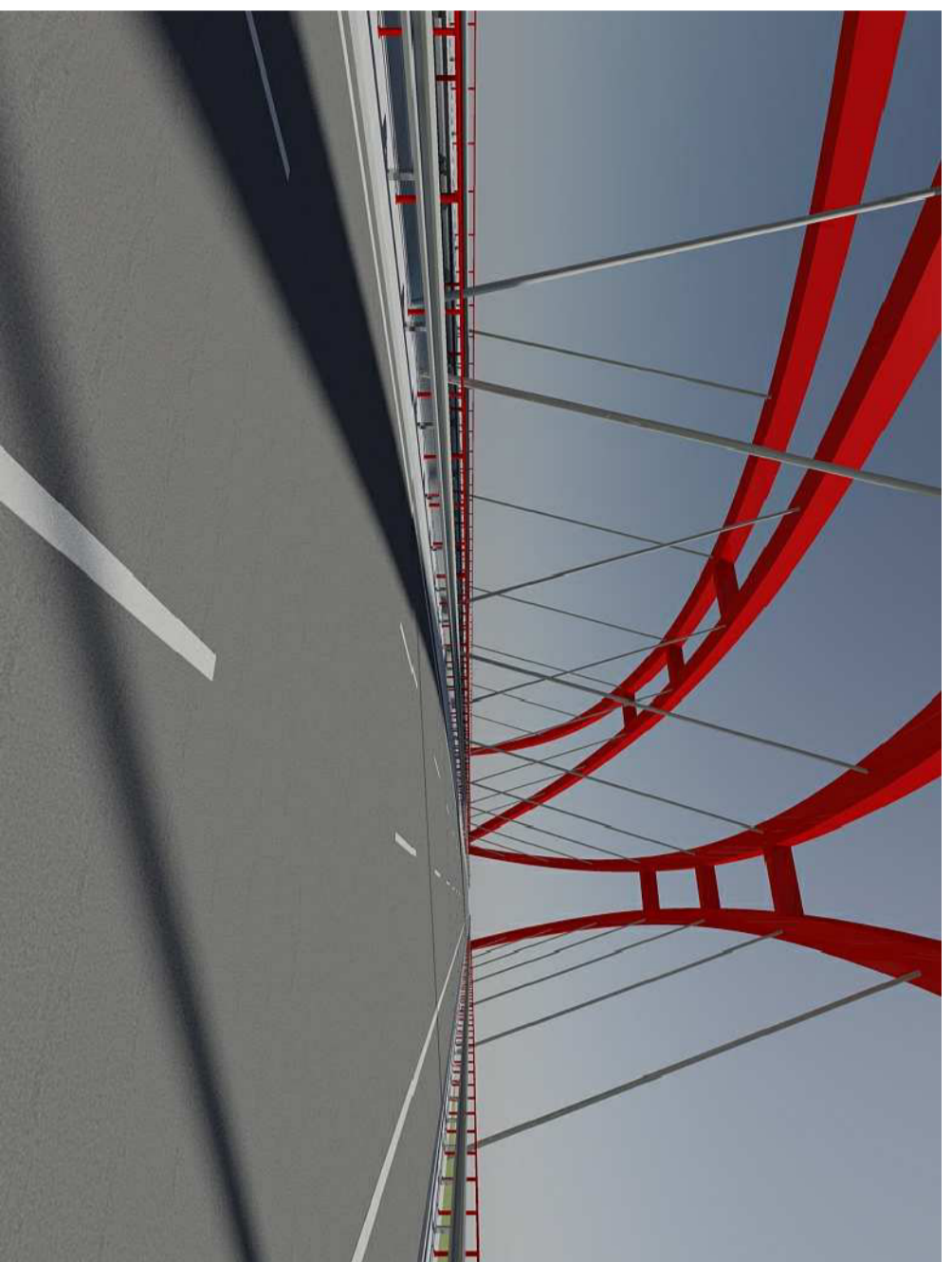
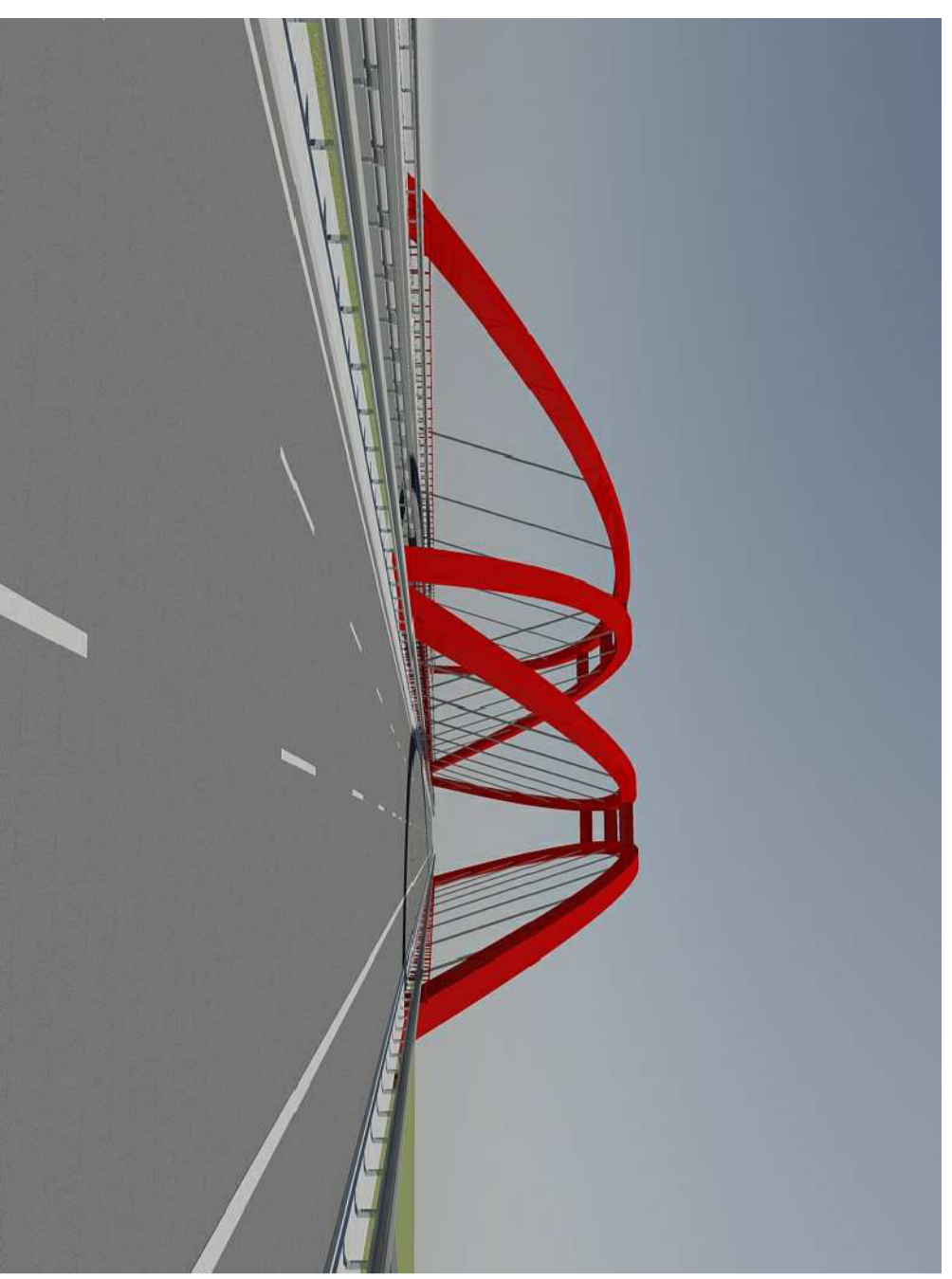

4			
3			
2			
1			

RUHBERG INGENIEURE
 58091 Hagen-Dahl, Homersstraße 10
 Tel.: 02337 - 985 - 0

BAB A42
 Ersatzneubau
 Br. u.d. Rhein-Herne-Kanal
 Essen-Nord

VORABZUG 20.03.2018